

NOTE:  
 ADDITIONAL CUTOUTS OR FRAMING MAY BE REQUIRED DEPENDING ON THE MACHINE ROOM LAYOUT. SEE MACHINE ROOM DRAWING OR CONTACT DEALER FOR MORE INFORMATION.

(4) 1 3/4" x 9 1/2"  
 LAMINATED VENEER LUMBER (LVL)  
 HEIGHT OF HOISTWAY IS USED  
 TO ANCHOR RAIL BRACKETS

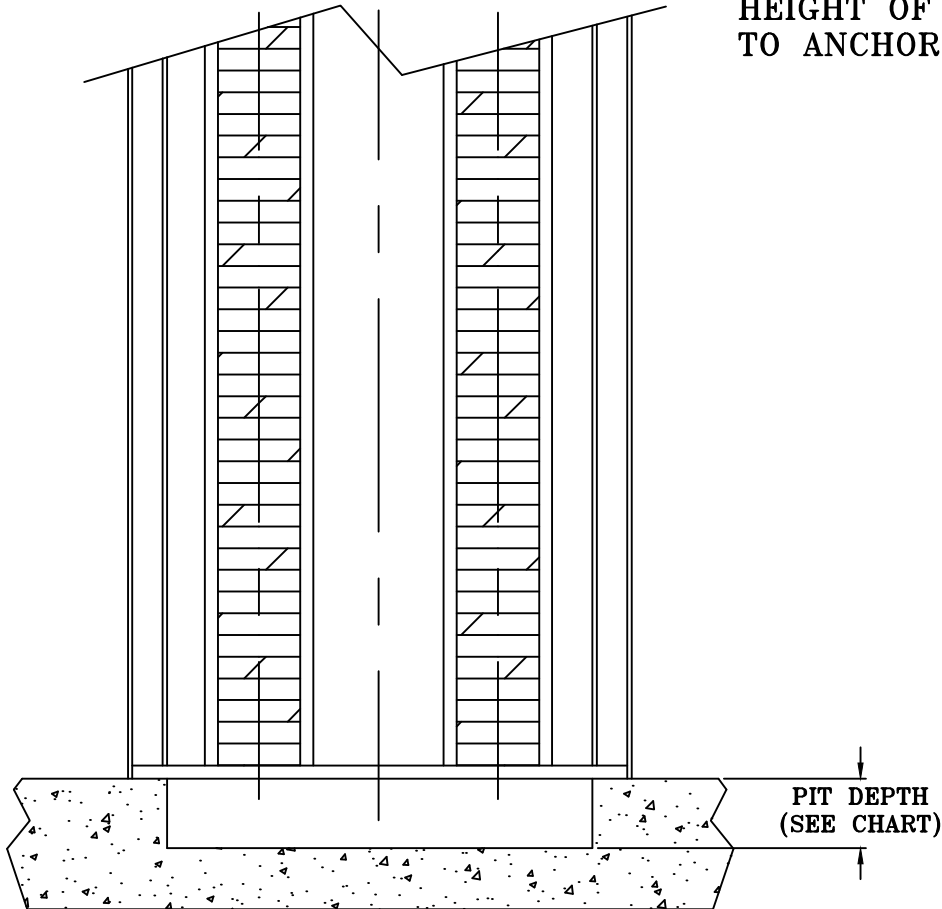

ELEVATOR MODEL	STANDARD PIT DEPTH	
	STANDARD	WITH BUFFER SPRING
EXCELEVATOR	10"	17"
EXCELEVATOR RMR	10"	17"
EXCELEVATOR MRL	10"	17"
PACA-RYDE	8"	15"
PACA-LIFT	8"	15"
PACA-GLIDE	8"	15"

PLEASE CONTACT FOX VALLEY ELEVATOR FOR MINIMUM PIT DEPTH  
 STANDARD PIT DEPTH IS BASED ON MAXIMUM FLOOR THICKNESS OF 1 3/4"

NOTE:  
 THIS DRAWING DEPICTS SAMPLE CONSTRUCTION ONLY. IT IS THE RESPONSIBILITY OF THE INSTALLER, CONTRACTOR, OR ENGINEER TO DESIGN AND SPECIFY STRUCTURAL SUPPORTS. ALL CONSTRUCTION TO BE IN COMPLIANCE WITH LOCAL CODES.

**FOX VALLEY** 1726 North Ballard Road  
 Appleton, WI 54911  
 Phone: 800-238-8739

# ELEVATOR™

ELEVATOR CONTRACTOR:			
JOB NAME:		ORDER NUMBER:	
<b>UNIVERSAL RAIL BACKING          FOR PACA &amp; EXCELEVATOR          SERIES ELEVATORS</b>			
DRAWN BY:	DATE:	SIGNATURE OF APPROVAL	DWG. NO. C-003015