



OWNERS GUIDE

Residential Dumbwaiter

Series: F007, F011

1726 North Ballard Road, Suite 1 • Appleton, WI 54911
Phone 920-991-9082 • Fax 920-991-9087
Technical Support 855-804-5774

Congratulations!

On your choice of a Fox Valley Elevator, Dumbwaiter.

Your dumbwaiter is manufactured in accordance with the ASME A17.1/ CSA B44 Safety Code for Elevators and Escalators.

Properly used and maintained, your new dumbwaiter will give you many years of excellent service. However, you must be sure to follow all safety procedures.

This Owner's Guide should be reviewed periodically and saved for future reference.

Members Of:

Fox Valley Elevator, is a proud member of The American Society of Mechanical Engineers, The National Association Elevators Contractors, The Canadian Elevator Contractor Association, The Accessibility Equipment Manufacturers Association. These symbols assures you of our commitment to high quality and accessibility to everyone.



Table of Contents

Introduction.....	4
Serial Number	4
Maintenance and Service	4
Safety Features.....	5
Important Operating Notes.....	6
Basic Dumbwaiter Operating Instructions/Assumption of Risk.....	7
Descriptive Features.....	8-11
Basic Troubleshooting.....	12
Notes.....	13

Note: The descriptions and specifications contained in this guide were in effect at the time the guide was approved for printing. Fox Valley Elevator, reserves the right to discontinue models without notice and without incurring obligation. The equipment described within this guide may not be identified as either standard or optional and the various illustrations may not all be applicable to your particular unit. Always check with your Elevator Dealer if you have questions.

*Fox Valley Elevator. will be referred as FVE through out the remainder of this document.

Introduction

Your dealer will instruct you on the proper and safe operation of your Fox Valley Elevator, Dumbwaiter. **IT IS IMPORTANT THAT YOU READ THIS *OWNER'S GUIDE* CAREFULLY BEFORE USING YOUR NEW DUMBWAITER.**

Your dumbwaiter was designed for years of dependable service. However, as with all electrical and mechanical equipment, proper operation and periodic maintenance is absolutely required. Maintenance instructions are available and are to be used by qualified personnel only. For optimal performance, Fox Valley Elevator recommends that you establish a annual maintenance agreement with your elevator contractor.

Dumbwaiter Serial Number



This serial number contains specific information about your dumbwaiter, allowing technicians to properly identify replacement parts.

Maintenance and Service

Dumbwaiter Dealer Information

Company: _____

Address: _____

Contact: _____

Phone Number: _____

If you have questions concerning the operation or maintenance requirements of your dumbwaiter, please contact the local dealer listed above. FVE suggests that you develop an ongoing relationship with your dealer for routine servicing and periodic maintenance. Do not try to service or repair the dumbwaiter yourself.

Safety Features













Your FVE dumbwaiter is equipped with many safety features you should be aware of.

- **Broken Rope Safety.** Mechanically stops the dumbwaiter if the cable breaks or slacks.
- **Slack Cable Switch.** Electrically prevents the dumbwaiter from operating if the cables become slack or breaks.
- **Car Gate Switch.** The dumbwaiter will not operate if a gate is open.
- **Final Limit Switch.** Stops the dumbwaiter if unit travels beyond normal operating limits.
- **Hoistway Door Interlocks.** This renders the dumbwaiter inoperable while a hoistway door is open, and locks the door when the dumbwaiter is not at the floor.
- **Buffer springs.** If present, a device with one or more springs to cushion the impact of descending dumbwaiter.

Important Operating Notes



Designates a condition where failure to follow instructions or heed warning could result in serious personal injury or death. When you see this symbol **HEED IT'S MESSAGE**.

-  Anyone planning on using this dumbwaiter must be trained in its proper use and have read this owner's guide.
-  Do not allow unsupervised children to use this dumbwaiter!
-  Do not remove, bypass or alter various switches, controls and/or restraining devices. These are mandated by national and local safety codes. Any tampering could result in serious injury or death!
-  Never use your dumbwaiter as an elevator!
-  Never extend any body part or objects into your open hoistway... to do so could damage your dumbwaiter, cause serious injury or death!
-  Do not exceed maximum capacity of dumbwaiter (see car capacity plate).
-  Never open a gate, or hoistway door, while the dumbwaiter is in motion (it will stop the dumbwaiter).
-  If you detect a problem with your dumbwaiter, do not use it. Call your dealer immediately.
-  Do not use this dumbwaiter in the event of fire, smoke, flooding, or earthquake.
-  Keep your dumbwaiter clean and free of debris.
-  Observe, read and obey the warning labels, tags, and symbols, as they are provided by the manufacturer for your safety.
-  Safe operation requires a maintained hoistway temperature of between 60° - 110°F with a relative humidity not to exceed 95%. Do not expose electrical components to the elements or extreme temperature fluctuations. Resulting condensation will damage equipment, causing it to malfunction. If exposed, let sit for 12-24 hours prior to operation.

Basic Dumbwaiter Operating Instructions

1. **Press the “Floor or Up/Down” Button.** This will call the dumbwaiter to your floor.
2. **Open the Hoistway Door.** Open the door once the dumbwaiter has come to a complete stop at your floor.
3. **Open the Gate.**
4. **Load/Unload the Dumbwaiter.**
5. **Close the Gate and Hoistway Door.** The dumbwaiter will not operate unless the gate and the entry door are both completely closed.
6. **Press the “ Floor or Up/Down” Button.** Send the dumbwaiter to the floor of your choice.
7. **Complete Stop.** Wait for the dumbwaiter to come to a complete stop.
8. **Open the Hoistway Door and Gate.**
9. **Load/Unload the Dumbwaiter.**
10. **Close Gate and Hoistway Door.** Completely close both the gate and the entry door of the dumbwaiter. The dumbwaiter will not respond to another call if either the gate or the entry door is not completely closed.

Assumption of Risk

ALL PERSONS who use this DUMBWAITER bear the responsibility for proper use of this product.

Misuse, deliberate or otherwise, voids all warranties... written or expressed!

Fox Valley Elevator, is NOT responsible for any damage, injury or death resulting from improper installation, modification, additions or other changes which take place after the product has left the manufacturer's plant.

Descriptive Features

It is important that you familiarize yourself with the features of your FVE Dumbwaiter before using.

Slide-Up

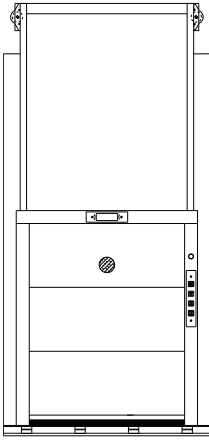

Bi-Part

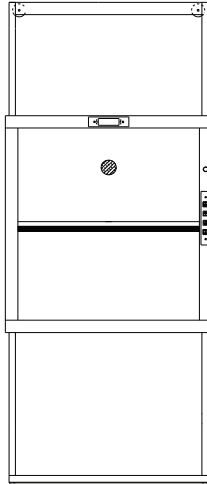

Swing Door

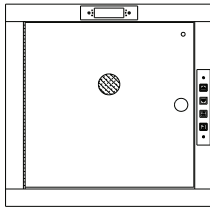

Hoistway Doors

The door prevents items from accidentally entering the hoistway when the dumbwaiter car is elsewhere. An interlock located at each opening prevents the door from being opened if the dumbwaiter car is not waiting at that landing. Every opening must have a door.

Hall Station

Hall Station will be located near the hoistway door.



- **“Floor or Up/Down” Button.** Press this button to call or send the car. The halo or back light will illuminate to acknowledge call and stay lit until arrival upon floor.
- **“Car Here” Indicator Light.** If present, this button will illuminate when the dumbwaiter has reached your floor.
- **Maintenance.** Clean your hall station plate with a clean cloth. Do not use harsh chemicals or abrasive cleaners.



Horizontal



Vertical

Stand-Alone Position Indicator (Optional)

If present it will be located near the hoistway door.

- **Display.** The LED display lets the user know what floor the dumbwaiter car is on.
- **Maintenance.** Clean your stand-alone position indicator with a clean cloth. Do not use harsh chemicals or abrasive cleaners.

Descriptive Features

It is important that you familiarize yourself with the features of your FVE Dumbwaiter before using.

Typical Gates

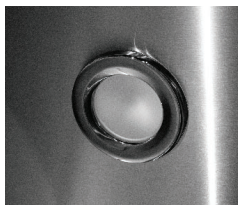
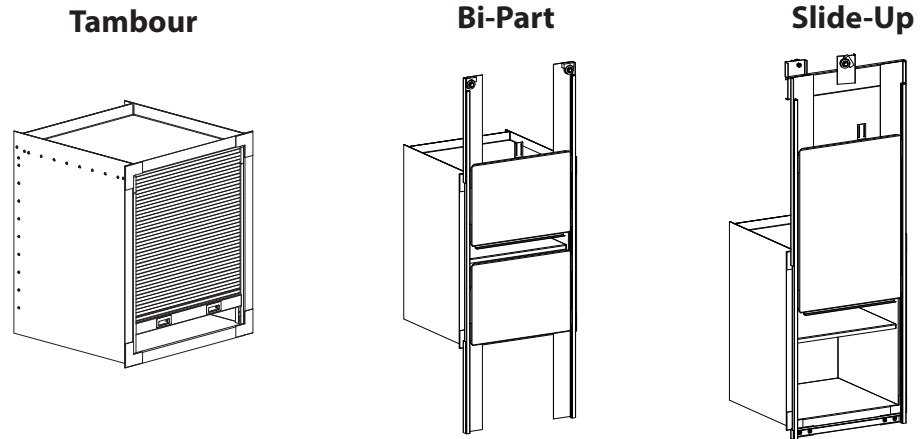

Car Light (Optional)

Illuminates normally when the car gate and/or hoistway door is open.

Adjustable Shelving (Optional)

If present it will be located inside the dumbwaiter car.

- **Adjustable.** The shelving can be moved inside the dumbwaiter car and positioned in any location as desired. All you have to do is move the (4) shelf clips to the same height on the shelf standard. When placing the shelf back in the dumbwaiter, verify that the shelf is sitting on the shelf clips solid and is level and plumb.
- **Maintenance.** Clean your dumbwaiter shelving with a soft clean cloth or sponge with a solution of warm water and mild detergent.

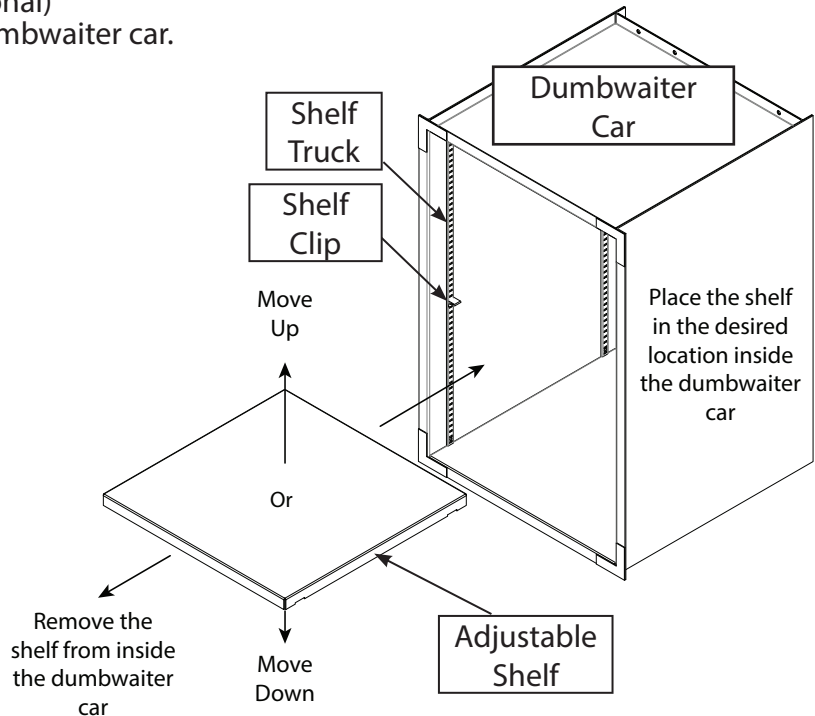

Descriptive Features

It is important that you familiarize yourself with the features of your FVE Dumbwaiter before using.

Lantern & Chime (Optional)



If present it will be located near the hoistway door.

Upon arrival, lantern illuminates and chimes once.

If interlock timer is enabled, light will illuminate until timer expires.

- **Maintenance.** Clean your hall station plate with a clean cloth. Do not use harsh chemicals or abrasive cleaners.
-

Door Open Buzzer/Bell

If present, the buzzer/bell will ring notifying the user that the gate(s) are not fully closed at the dumbwaiter's current location.

Hoistway Door Interlock (Residential Units Only)

The interlock is located inside the hoistway at the top corner or in the door jamb on the latch side of the door. This locks the hoistway door when the car is not at a landing.

- **Emergency Key.** Can be used to open the door from outside the hoistway in case of emergency or for servicing. **This key is to be used only for emergencies.**
- **GAL Interlock.** Insert the emergency release key into the hole (near the top of the door) and turn (toward the center of the door) to release the interlock while opening the door.
- **EMI-III Interlock.** Insert the emergency release key into the hole (near the top of the door) and pull center downward to release the interlock while opening the door.

GAL Interlocks:

Insert the key and twist, while opening the door.

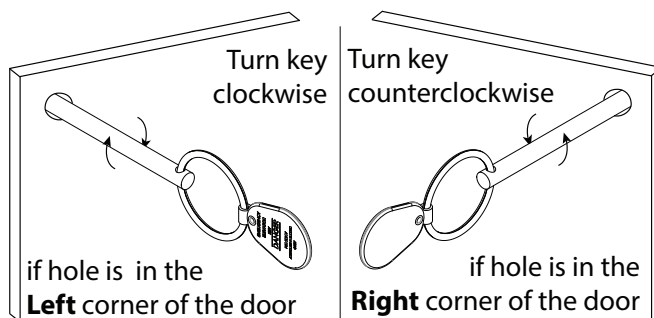

EMI Interlocks:

Insert key in a slight downward angle and gently pull/press down on the key, while opening the door.

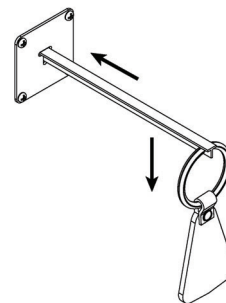

Descriptive Features

It is important that you familiarize yourself with the features of your FVE Dumbwaiter before using.

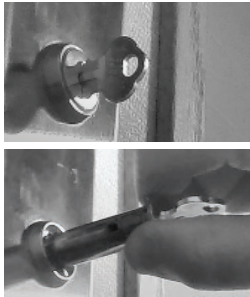

HG-1 or HG-2 Keylock

(Commercial Standard/ Residential Optional)

Disengage the HG-1 or HG-2 Keylock by inserting the key, turning and pulling lock outward until gate opens. Lock the gate by pushing lock mechanism back into place, turning and then removing key.

Basic Troubleshooting

Before Calling for Service...

Check to see if you press the call button and hear the buzzer/bell. This signals a hoistway door or gate is open.

Verify that all gates and doors are securely closed by opening and closing them. The dumbwaiter will not operate when a gate or door is partially open.

Verify the disconnect switch is in the "ON" position.

Wait 7 seconds between calls.

Do not attempt to repair the dumbwaiter yourself.

If your dumbwaiter still does not function call your dealer immediately.

1726 North Ballard Road, Suite 1 • Appleton, WI 54911
Phone 920-991-9082 • www.foxvalleyelevator.com

PM0003-E
11 APR 2022