



OWNERS GUIDE

Commercial Dumbwaiter

Series: F311, F511

1726 North Ballard Road, Suite 1 • Appleton, WI 54911
Phone 920-991-9082 • Fax 920-991-9087
Technical Support 855-804-5774

Congratulations!

On your choice of a Fox Valley Elevator, LLC Dumbwaiter.

Your dumbwaiter is manufactured in accordance with the ASME A17.1/CSA B44 Safety Code for Elevators and Escalators.

Your new dumbwaiter will give you many years of excellent service with proper maintenance and use. However, you must always follow all safety procedures.

This Owner's Guide should be reviewed periodically and saved for future reference.

Members Of:

Fox Valley Elevator, LLC is a proud member of The American Society of Mechanical Engineers, The National Association Elevator Contractors, The Canadian Elevator Contractor Association, The Accessibility Equipment Manufacturers Association. These symbols assures you of our commitment to high quality and accessibility to everyone.



Table of Contents

Introduction.....	4
Serial Number	4
Maintenance and Service	4
Important Operating Notes/Assumption of Risk.....	5
Safety Features.....	6
Basic Dumbwaiter Operating Instructions.....	7
Descriptive Features.....	8-10
Basic Troubleshooting.....	11
Description of Programs and Features.....	12
Notes.....	13
Limited Warranty.....	14-15

Note: The equipment described within this guide may not be identified as either standard or optional and the various illustrations may not all be applicable to your particular unit. Always check with your authorized dealer if you have questions.

*Fox Valley Elevator, LLC will be referred as Fox Valley Elevator or FVE through out the remainder of this document.

Introduction

Your dealer will instruct you on the proper and safe operation of your Fox Valley Elevator, Dumbwaiter. **IT IS IMPORTANT THAT YOU READ THIS *OWNER'S GUIDE* CAREFULLY BEFORE USING YOUR NEW DUMBWAITER.**

Your dumbwaiter was designed for years of dependable service. However, as with all electrical and mechanical equipment, proper operation and periodic maintenance is absolutely required. Maintenance instructions are available and are to be used by qualified personnel only. For optimal performance, Fox Valley Elevator recommends that you establish a periodic maintenance agreement with your elevator authorized dealer. Do not try to service or repair the dumbwaiter yourself.

Dumbwaiter Serial Number



This serial number contains specific information about your dumbwaiter, allowing technicians to properly identify replacement parts.

Maintenance and Service

Dumbwaiter Dealer Information

Company: _____

Address: _____













Contact: _____

Phone Number: _____

Important Operating Notes



Designates a condition where failure to follow instructions or heed warning could result in serious personal injury or death. When you see this symbol **HEED IT'S MESSAGE.**

-  Anyone planning on using this dumbwaiter must be trained in its proper use and have read this owner's guide.
-  Do not allow unsupervised children to use this dumbwaiter!
-  Do not remove, bypass or alter various switches, controls and/or restraining devices. These are mandated by national and local safety codes. Any tampering could result in serious injury or death!
-  Never use your dumbwaiter as an elevator!
-  Never extend any body part or objects into your open hoistway... to do so could damage your dumbwaiter, cause serious injury or death!
-  Do not exceed maximum capacity of dumbwaiter. A capacity tag is posted in the Dumbwaiter car.
-  Never open a gate, or hoistway door, while the dumbwaiter is in motion (it will stop the dumbwaiter).
-  If you detect a problem with your dumbwaiter, do not use it. Call your dealer immediately.
-  Do not use this dumbwaiter in the event of fire, smoke, flooding, or earthquake.
-  Keep your dumbwaiter clean and free of debris.
-  Observe, read and obey the warning labels, tags, and symbols, as they are provided by the manufacturer for your safety.
-  Safe operation requires a maintained hoistway temperature of between 60° - 110°F with a relative humidity not to exceed 95%. Do not expose electrical components to the elements or extreme temperature fluctuations. Resulting condensation will damage equipment, causing it to malfunction. If exposed, let sit for 12-24 hours prior to operation.

Assumption of Risk

ALL PERSONS who use this DUMBWAITER bear the responsibility for proper use of this product.

Misuse, deliberate or otherwise, voids all warranties... written or expressed!

Fox Valley Elevator, is NOT responsible for any damage, injury or death resulting from improper installation, modification, additions or other changes which take place after the product has left the manufacturer's plant.

Safety Features

Your FVE dumbwaiter is equipped with many safety features you should be aware of.

- **Broken Rope Safety.** Mechanically stops the dumbwaiter if the cable breaks or slacks.
- **Slack Cable Switch.** Electrically prevents the dumbwaiter from operating if the cables become slack or breaks.
- **Car Gate Switch.** The dumbwaiter will not operate if a gate is open.
- **Final Limit Switch.** Stops the dumbwaiter if unit travels beyond normal operating limits.
- **Hoistway Door Interlocks.** This renders the dumbwaiter inoperable while a hoistway door is open, and locks the door when the dumbwaiter is not at the floor.
- **Buffer springs.** If present, a device with one or more springs to cushion the impact of descending dumbwaiter.

DO NOT TAMPER WITH ANY SAFETY FEATURE!

Basic Dumbwaiter Operating Instructions

- 1. Press the “Floor or Up/Down” Button.** This will call the dumbwaiter to your floor.
- 2. Open the Hoistway Door.** Open the door once the dumbwaiter has come to a complete stop at your floor.
- 3. Open the Gate.**
- 4. Load/Unload the Dumbwaiter.**
- 5. Close the Gate and Hoistway Door.** Completely close both the gate and the entry door of the dumbwaiter. The dumbwaiter will not respond to another call if either the gate or the entry door is not completely closed
- 6. Press the “ Floor or Up/Down” Button.** Send the dumbwaiter to the floor of your choice.
- 7. Complete Stop.** Wait for the dumbwaiter to come to a complete stop.
- 8. Open the Hoistway Door and Gate.**
- 9. Load/Unload the Dumbwaiter.**
- 10. Close Gate and Hoistway Door.** Completely close both the gate and the entry door of the dumbwaiter. The dumbwaiter will not respond to another call if either the gate or the entry door is not completely closed.

Descriptive Features

It is important that you familiarize yourself with the features of your FVE Dumbwaiter before using.

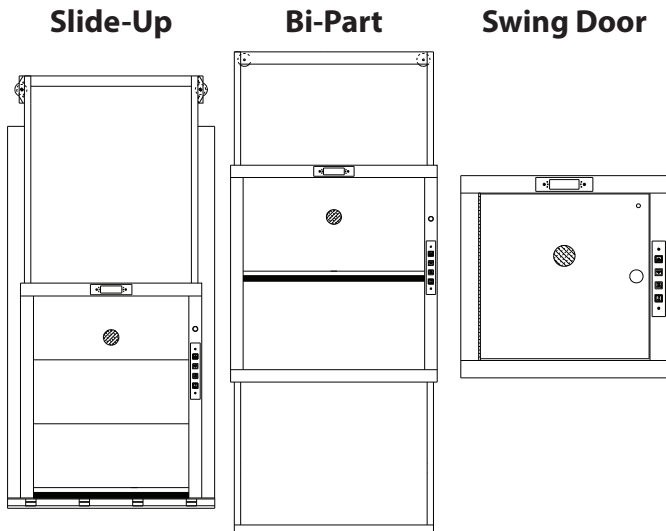

Hoistway Doors

The door prevents items from accidentally entering the hoistway when the dumbwaiter car is elsewhere. An interlock located at each opening prevents the door from being opened if the dumbwaiter car is not waiting at that landing. Every opening must have a door.

Hall Station

Hall Station will be located near the hoistway door.



- **“Floor or Up/Down” Button.** Press this button to call or send the car. The halo or back light will illuminate to acknowledge call and stay lit until arrival upon floor.
- **“Car Here” Indicator Light .** If present, this button will illuminate when the dumbwaiter has reached your floor.
- **Maintenance.** Clean your hall station plate with a clean cloth. Do not use harsh chemicals or abrasive cleaners.



Horizontal



Vertical

Stand-Alone Position Indicator (Optional)

If present it will be located near the hoistway door.

- **Display.** The LED display lets the user know what floor the dumbwaiter car is on.
- **Maintenance.** Clean your stand-alone position indicator with a clean cloth. Do not use harsh chemicals or abrasive cleaners.

Descriptive Features

It is important that you familiarize yourself with the features of your FVE Dumbwaiter before using.

Lantern & Chime (Optional)



If present it will be located near the hoistway door.

Upon arrival, lantern illuminates and chimes once.

If interlock timer is enabled, light will illuminate until timer expires.

- **Maintenance.** Clean your hall station plate with a clean cloth. Do not use harsh chemicals or abrasive cleaners.
-

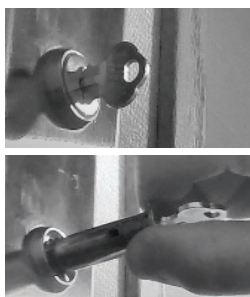

HG-1 or HG-2 Keylock

(Commercial Standard/ Residential Optional)

Disengage the HG-1 or HG-2 Keylock by inserting the key, turning and pulling lock outward until gate opens. Lock the gate by pushing lock mechanism back into place, turning and then removing key.

Hoistway Door Interlock (Residential Units Only)

The Hoistway Door Interlock locks the hoistway door when the car is not at that landing. Located inside the hoistway at the top corner on the latch side of the door jamb.

- **Emergency Key.** Can be used to open the door from outside the hoistway in case of emergency. To unlock a door, insert the emergency.

Release key into the hole (near the top of the door):

GAL Interlocks:

Insert the key and twist, while opening the door.

EMI Interlocks:

Insert key in a slight downward angle and gently pull/press down on the key, while opening the door.

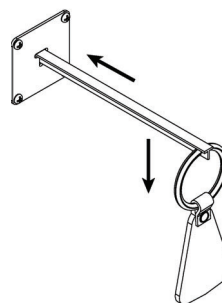
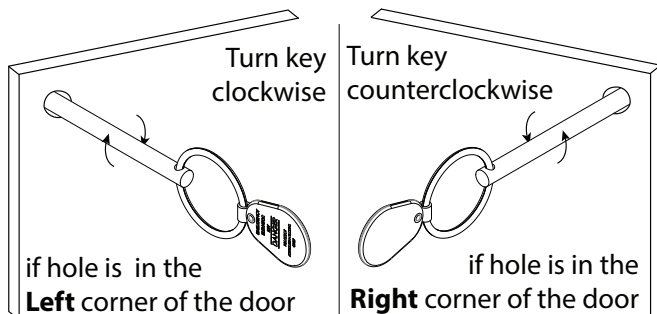

Descriptive Features

It is important that you familiarize yourself with the features of your FVE Dumbwaiter before using.

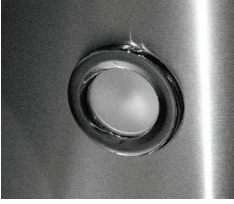

Car Light (Optional)

Illuminates when the car gate and/or hoistway door is open.

Door Open Buzzer/Bell

If present, the buzzer/bell will ring notifying the user that the gate(s) are not fully closed at the dumbwaiter's current location.

Adjustable Shelving (Optional)

If present it will be located inside the dumbwaiter car.

- **Adjustable.** The shelving can be moved inside the dumbwaiter car and positioned in any location as desired. All you have to do is move the (4) shelf clips to the same height on the shelf standard. When placing the shelf back in the dumbwaiter, verify that the shelf is sitting on the shelf clips solid and is level and plumb.
- **Maintenance.** Clean your dumbwaiter shelving with a soft clean cloth or sponge with a solution of warm water and mild detergent.

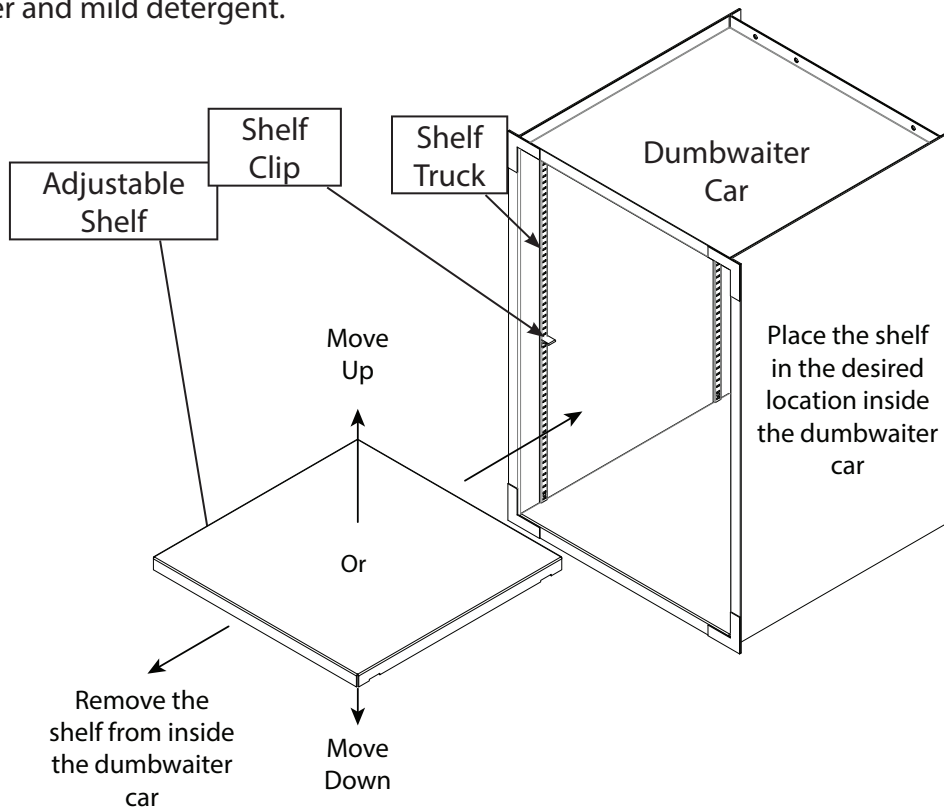

Basic Troubleshooting

Before Calling for Service...

Check to see if you press the call button and hear the buzzer/bell. This signals a hoistway door or gate is open.

Verify that all gates and doors are securely closed by opening and closing them. The dumbwaiter will not operate when a gate or door is partially open.

Verify that the disconnect switch is in the "ON" position.

Wait 7 seconds between calls.

Do not attempt to repair the dumbwaiter yourself.

If your dumbwaiter still does not function call your authorized dealer immediately.

Description of Programs & Features

- **Automatic Homing Feature.** After a time period of 5 to 30 minutes with no floor calls, this feature allows the dumbwaiter to home to a floor of your choice. All gates and doors are required to be in the fully closed position for the timer to begin counting. Please contact your local dealer if you require your timer to be adjusted.

Turn Automatic Homing Feature “On”.

1. Call unit to the lowest floor, and open the door and gate.
2. Press & hold floor 1 & 2 buttons (or up & down arrows) until they illuminate.
3. Press the desired floor call button until floor call buttons 1 & 2 turn “Off” (or up & down arrows). This tells the controller which floor will become the home location.
4. The selected automatic homing floor will illuminate briefly. If this does not occur repeat previous steps.
5. Close all gates and doors to start the homing timer.

Turn Automatic Homing Feature “Off”.

1. Call unit to the lowest floor, and open the door and gate.
2. Press & hold floor 1 & 2 buttons (or up & down arrows) until they illuminate. Continue to hold both call buttons until the call button lights turn “Off”.

- **Gate Cycle Safety Feature.** If the gate has not been opened and closed after 4 calls, the dumbwaiter will stop taking floor calls. To reset the dumbwaiter, the gate must be opened and closed before another call is placed. Then place a call to the desired floor.
- **Interlock Timer.** This feature is only available for commercial dumbwaiters that are installed in commercial applications that are equipped with mechanical interlocks and ignore this feature. Residential applications and equipped with electromechanical interlocks EMI. Please note that the car indicator light (Car Here or Lantern depending on your application) functions in tandem with this feature for both commercial and residential applications, with either EMI or mechanical interlocks.
 - If this feature is turned “OFF” you will be able to open the door at your immediate floor when the dumbwaiter car is present. If turned “ON”, when the unit arrives at the floor, the interlock will remain unlocked for a time period of 10 to 60 seconds. After the set time period has expired, the user will be required to press the immediate floor call button to open the door.
 - The car indicator light (Car Here or Lantern depending on your application) will light in tandem with the interlock timer, even if the interlock is mechanical. Please contact your local dealer if you require your interlock timer to be adjusted or turned On/Off.
- **Low Speed EZ Search Feature.** If the dumbwaiter car stops short of the floor, the controller will initiate the Low Speed EZ Search Feature. The dumbwaiter car will begin moving again in the same direction of travel approximately 1/3 of travel speed for 120 seconds, or until the floor is located. When this feature is initiated the controller will count this action as a second call. This is important to note when keeping track of the counting in the Gate Cycle Safety Feature.



MANUFACTURER'S LIMITED PRODUCT WARRANTY

Fox Valley Elevator LLC. ("Fox Valley Elevator") warrants each new elevator and dumbwaiter to be free from manufacturing defects in material and workmanship under normal use and service for 10 years on structural components: rail and brackets, pedestal base, pedestal, jack bracket, jack cup, sling except movable components, buffer springs, bases and stands. 3 years on mechanical components: sheaves, ram heads, powerheads, car with exceptions for unfinished cars, gate operator except for electrical components, car gates, flexible hoses, access doors, safeties, handrails. 1 year on electrical components: Printed circuit boards, switches, push buttons, motors, drives, power supplies, travel cable, lights and light controllers, PLC'S and other electrical components commencing on the date of shipment from Fox Valley Elevator's factory. Fox Valley Elevator warrants each elevator modification package to be free from manufacturing defects in material and workmanship under normal use and service for a period eighteen (18) months commencing on the date of shipment from Fox Valley Elevator's factory. Fox Valley Elevator warrants each replacement part to be free from manufacturing defects in material and workmanship under normal use and service for ninety (90) days commencing on the date of shipment from Fox Valley Elevator's factory. THIS LIMITED WARRANTY APPLIES ONLY TO THE ORIGINAL END USER AT THE ORIGINAL INSTALLATION LOCATION AND IS NOT TRANSFERABLE.

Conditions:

1. This Warranty only applies to new elevators, new dumbwaiters, and new elevator modification packages installed by an authorized Fox Valley Elevator Dealer in conforming with current code compliance.
2. This Limited Warranty is void if periodic maintenance of the elevator, dumbwaiter or new elevator modification packages is not being performed by a trained Elevator Technician, Mechanic, or Elevator Personnel in accordance with the recommendations contained in the Owner's Guide. It is the owner's and/or Elevator Technician, Mechanic, or Elevator Personnel's responsibility to keep records of all such service on site. To maintain warranty, elevators, dumbwaiters, and elevator modifications installed in harsh environments (for example, saltwater exposure, aerosolized chemicals, temperature extremes, etc.), will require additional periodic maintenance.

Additional Disclaimers:

The sole remedy and Fox Valley Elevator's entire liability under this Limited Warranty is limited to the supply of repair or replacement parts for any defective product or component within the term of this Limited Warranty, as Fox Valley Elevator determines appropriate. Replacement items are warranted under this Limited Warranty for the remaining period of the initial warranty. No oral or written information or advice given by Fox Valley Elevator, its dealers or other distributors, agents or employees shall create any different or additional warranties or in any way increase the scope of this Limited Warranty.

This Limited Warranty does not apply to the following: (1) consumable items 'including but not limited to', light bulbs, batteries, uninterruptible power supplies, oil seals, guide shoes, rollers, drive belts, wire rope, greases, oils. (2) 'including but not limited to', components that are subject to normal wear and



tear, external forces and/or misuse, including metal panels, glass, acrylic, gates, doors, buttons, switches, trim, brake pads, fuses, relay, rectifier. (3) items that require periodic assessment, maintenance and/or replacement. (4) minor mechanical adjustments (such as tightening of nuts, bolts, screws, or realignment of component.)

This Limited Warranty does not cover labor charges for the diagnosis, removal, repair, or replacement of warranty parts. This Limited Warranty does not extend to any nonconformity or defect due to any of the following: failure to comply with recommended maintenance as outlined in the Owner's Guide, installation or service by a non-certified technician or using non-certified parts, misuse, neglect, accident, abuse, modification, user's negligence, improper operation (operation not in accordance with Owner's Guide), fire, flood, electrical surges, acts of God, other external forces, ordinary wear and tear, damage during shipment, improper assembly or installation, or any other reason not due to a manufacturing defect.

FOX VALLEY ELEVATOR SHALL NOT HAVE ANY LIABILITY TO ANY PERSON FOR INCIDENTAL, CONSEQUENTIAL OR SPECIAL DAMAGES OF ANY DESCRIPTION, WHETHER ARISING OUT OF WARRANTY (INCLUDING ANY IMPLIED WARRANTIES) OR ANY OTHER CONTRACT, NEGLIGENCE OR OTHER TORT, OR OTHERWISE. UNDER NO CIRCUMSTANCE SHALL FOX VALLEY ELEVATOR'S LIABILITY EXCEED THE PURCHASE PRICE RECEIVED BY FOX VALLEY FOR THE SPECIFIC ITEM AT ISSUE. Some states do not allow the exclusion or limitation of incidental or consequential damages, so the above limitation and exclusion may not apply to you. This Limited Warranty gives you specific legal rights and you may also have other rights, which vary from state to state.

THIS LIMITED WARRANTY IS THE SOLE AND EXCLUSIVE WARRANTY PROVIDED BY FOX VALLEY ELEVATOR AND IS IN LIEU OF ALL OTHER WARRANTIES, WRITTEN OR ORAL, EXPRESS OR IMPLIED, ARISING BY OPERATION OF LAW OR OTHERWISE. ALL IMPLIED WARRANTIES, INCLUDING IMPLIED WARRANTIES OF MERCHANTABILITY FITNESS FOR A PARTICULAR PURPOSE, NONINFRINGEMENT AND WARRANTIES ARISING FROM COURSE OF DEALING OR USAGE OF TRADE, WHETHER OR NOT THE PURPOSE HAS BEEN DISCLOSED AND WHETHER OR NOT THE ELEVATOR HAS BEEN SPECIFICALLY DESIGNED OR MANUFACTURED FOR BUYER'S USE OR PURPOSE, ARE EXPRESSLY DISCLAIMED AND UNDER NO CIRCUMSTANCE EXTEND BEYOND THE ABOVE STATED LIMITED WARRANTY PERIOD. Some states do not allow limitation on how long an implied warranty lasts, so the above limitation may not apply to you.

Submitting a Limited Warranty Claim

Warranty claims must be received by Fox Valley Elevator by email or phone and must be assessed and issued by Fox Valley Elevator's Technical Support Specialist within the warranty period.

FOX VALLEY ELEVATOR™

IS A PROUD MEMBER OF



Fox Valley Elevator, LLC is a proud member of the American Society of Mechanical Engineers (ASME), National Association of Elevator Contractors (NAEC), Canadian Elevator Contractors Association and Association of Members of the Accessibility Industry (AEMA). These symbols assure you of our commitment to high quality and accessibility to everyone.



800-238-8739
foxvalleyelevator.com
1726 North Ballard Road • Suite 1
Appleton, WI 54911
Info@foxvalleyelevator.com



MADE IN THE USA

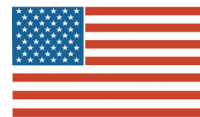

with US and Global Parts